

VISION PLUS have been developing successful innovative TV antennas for over 30 years.



British designed and manufactured, our STATUS antenna still leads the way and remains No.1.



The VISION PLUS range now includes our bespoke TV Wall Brackets, Televisions, Rear View Camera Systems and Solar Power Battery Chargers.



A proven range of individual, quality products representing value for money and supported by great customer service.



All Vision Plus products carry a

3
Year
WARRANTY

except where otherwise stated

VISION PLUS
...keeping you in the picture

T: 0115 986 7151
E: info@visionplus.co.uk
W: www.visionplus.co.uk

STATUS 570 & 580 Digital Antenna Systems



Now in its third generation since its launch in 2001 and still the industry's No.1 fitted Directional Antenna. Each evolution improving on the previous by adding additional features and enhanced levels of performance.

Designed as a permanently fitted antenna and based on a brand-new LTE protected dipole ensuring improved performance and compliance to the latest standards.

- Designed and manufactured in the UK
- Roof mounted amplified antenna and mast
- Powerful Digital UHF, FM & DAB performance
- Integrated Amplifier and TV Signal Finder
- Triple TV outlets with signal gain adjustment
- Dedicated radio outlet for FM & DAB radio
- Height, direction & orientation adjustable from inside
- Cants 90 degrees to receive vertical & horizontal signals
- Combination winder handle and polarisation gauge
- Designed for installation in most overhead lockers
- Low profile, head height of only 108mm

Frequency: TV 470-790 MHz
FM Radio 88-108 MHz
DAB Radio 220-240 MHz

Dimensions: 412 x 348 x 108mm

Short Mast intrusion into locker: 305-280mm

VP5 Amplifier & Signal Finder: 157 x 45 x 29mm



STATUS 350 & 355 Digital Antenna Systems



Launched in 1992 and still our most successful omni-directional antenna. A distinctive profile, high quality, powerful performance and versatility ensures it remains the market favourite. The latest evolution has improved performance and reception and a lower profile. Designed as a permanently fitted antenna, the 350 for UHF TV via the VP2 amplifier and the 355 for the added FM and DAB radio capabilities via the VP3 Amplifier*.

- Designed and manufactured in the UK
- Digital television signals & FM/DAB radio* reception
- Receives horizontal and vertical signals through 360°
- Powered amplifier with variable gain adjustment
- Fittings for roof, mast mount or optional sucker mount
- Angle adjustable for level mounting on a sloping surface
- Easily removable antenna dome

Frequency: TV 470-790 MHz
FM Radio 88-108 MHz (*355 only)
DAB Radio 220-240 MHz(*355 only)

Dimensions: 315dia x 180mm

VP2 Amplifier: 115 x 45 x 29mm

VP3 Amplifier: 157 x 45 x 29mm



Permanent



25mm Mast Fitting



Angle Adjustment



Suction Pad (optional)



Removable Antenna

STATUS 270 Digital Antenna System



Our latest design of omni-directional antenna is compact and lightweight utilising our latest most powerful dipole array. Designed around a narrow mounting foot, it's ideal for camper conversions with ridged roofs. Its lower profile and compact dimensions have produced our most discrete, permanently fitted, antenna to date.

- Designed and manufactured in the UK.
- Ideal for campervan conversions
- Low aerodynamic profile
- Lightweight compact design
- Narrow streamlined mounting foot
- Receives horizontal and vertical signals through 360°
- Powered amplifier with variable gain adjustment
- Easy to install, step-by-step instructions



VP2 Amplifier

Frequency: TV 470-790 MHz

Dimensions:

Antenna Dome: 270 x 285mm

Mounting Foot: 150 x 70mm

Height: Overall 136mm

Height: Foot 31mm

VP2 Amplifier: 115 x 46 x 29mm

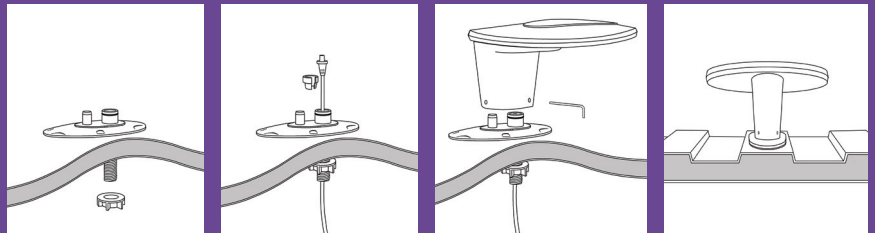

IMAGE 450 Digital Antenna



The IMAGE 450 is a new concept in directional antennas.

Drawing on the design of the Status Antenna, the enclosed LTE protect log periodic design provides powerful performance, comparable with much larger antennas.

The 450 Antenna will receive all UHF Digital TV plus the addition of FM* and DAB* radio when using the optional VP3 or VP5 amplifier, or the Vision Plus Diplexer.

Frequency: TV 470-790 MHz
FM Radio 88-108 MHz*
DAB Radio 220-240 MHz*

Dimensions: 412 x 348 x 80mm

Coaxial Cable: 5 metres & plug



IMAGE 420 & 430 Digital Antenna



The IMAGE 420 & 430 semi-enclosed dipoles produce a sleek, stylish profile and performance, comparable with much larger antennas.

The 420 receives all digital TV transmissions whilst the 430 has enhanced TV reception as well as FM radio.

Compatible with all the masts in the Vision Plus Range or any 25 mm diameter mast.

Frequency: TV 470-790 MHz
FM Radio 88-108 MHz (430 Only)

Dimensions: 410L x 330W x 45D mm
Coaxial Cable: 5 metres & plug

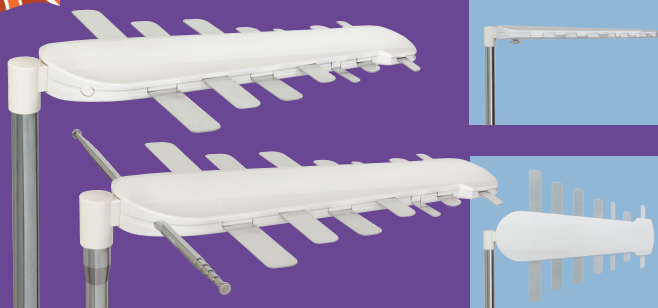

IMAGE 620 Digital Antenna System



A complete antenna system combining:

- IMAGE 420 UHF Digital Antenna
- Jockey Wheel bracket
- Three section mast & ground spike
- Flat Thru window cable, connector & fly lead

Frequency: UHF 470-790MHz
Dimensions: 410L x 330W x 45D mm
Mast Length: 2600mm
Coaxial Cable: 5metres & Plug.

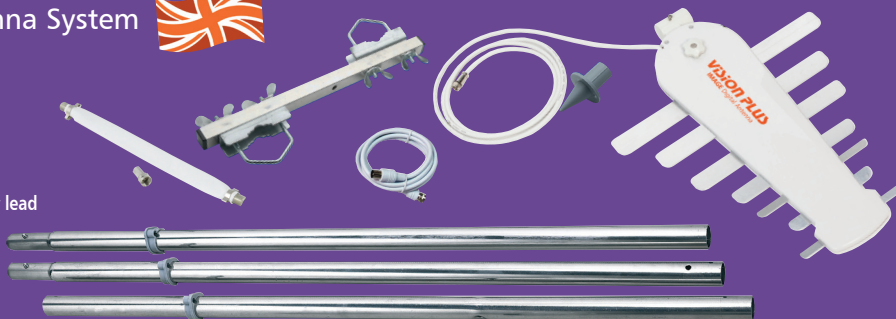

IMAGE 630 Antenna System



A complete antenna system combining

- IMAGE 430 UHF/FM Digital Antenna
- Uni-Bracket & self-adhesive mounting plate
- Four section telescopic mast & ground spike
- Flat Thru window cable, connector & fly lead

Frequency: UHF 470-790MHz
FM 88-108 MHz
Dimensions: 410L x 330W x 45D mm
Mast Length: 3450mm
Coaxial Cable: 5metres & Plug.



COMPACT 260 Digital Antenna

A UHF directional antenna designed for outdoor and indoor use.

Combined with the Vision Plus VP2 low noise, high gain amplifier, the 260 provides strong performance in medium to poor signal areas.

Being lightweight and compact and supplied with a number of standard fitting options being, suction pad base, pole or wall mount, it's the perfect companion where space is an issue.

Compatible with all the masts in the Vision Plus Range or any 25 mm diameter mast.



VP2 Amplifier

Frequency: UHF 470-790 MHz
Dimensions: 350 x 165 x 70mm
Coaxial Cable: 3 metres & plug

Wall Mount



Mast Mount



Sucker Mount



TV Digital Amplifiers

A range of high gain, digital, wide band amplifiers designed with low noise capabilities and variable gain adjustment. Ensures optimum performance and improved reception for all non-amplified antennas. 

VP2

- UHF TV



VP4

- UHF TV
- TV Signal Finder



VP3

- UHF TV
- FM & DAB Radio



VP5

- UHF TV
- FM & DAB Radio
- TV Signal Finder



To operate:

- Determine the polarization of the local TV transmitters.
- Switch on the amplifier
- Rotate the antenna
- **RED** - Keep turning the antenna
- **YELLOW** - Slow Down
- **GREEN** - TV Signals located

Jockey Wheel Mast

Designed to attach to the caravan jockey wheel or any vertical extrusion up to 55mm in diameter. Complete with 2.6m three section mast & ground spike. 

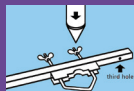
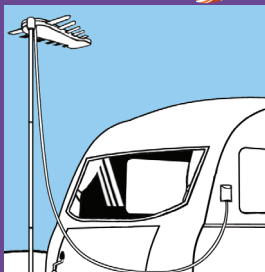

- Secured without the need for drilling
- Two sets of holes accommodate larger A-frames
- Quick and easy assembly when required

Uni-Mast

This versatile bracket clamps to a multitude of profiles or any vertical surface using the self-adhesive plate supplied. Complete with 2.6m three section mast & ground spike.

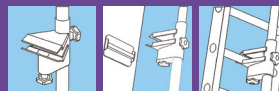
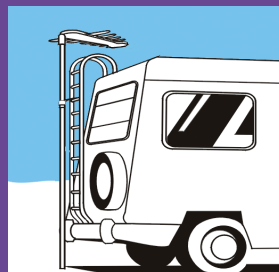

- Ideal for numerous horizontal profiles.
- Ladders, grab handles or awning channels
- Clamp Adjusts from 1-35mm

Telescopic Mast

This four-section mast comes with a ground spike and is ideal for use with all the Vision Plus mast brackets below.



- Four section mast extends to 3.5metres
- Only 1.1m when retracted
- Ground spike for soft standing



Mast Brackets

All our brackets come as part of a complete mast system, or can be used separately with any 25mm diameter mast.

Jockey Wheel Bracket



Uni-Bracket

External TV Sockets

Allows the connection of an external antenna and/or satellite to an internal TV point. All connections are protected from the weather by a hinged cover. Complete with 5 metres of coaxial cable.

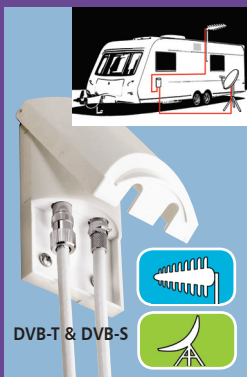

DVB-T & DVB-S



DVB-T

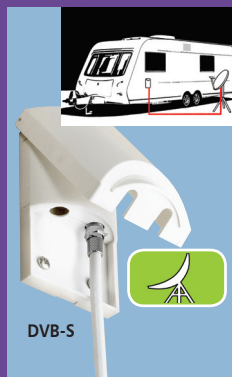

DVB-S

Electronic Radio Antenna

Our 8-section telescopic radio antenna is designed for use with a car style radio to receive AM and FM transmissions. The power supply comes from the radio unit.

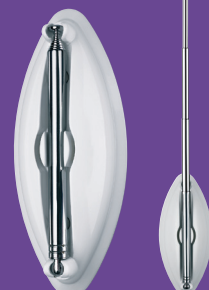

VISION PLUS Portable Televisions



Specially designed for mobile use, our TVs represent proven quality, innovation and design, combined with great customer care and value for money.

- Built-in Free-To-Air HD Satellite Receiver
- Digital FREEVIEW HD receiver
- Non-reflective Screen
- 12/24 Volt and Mains powered
- Very low power consumption
- Lightweight and compact design
- Quick Start Tune facility - QST
- USB 'Record & Pause' live TV
- VESA Wall mount facility
- Wide viewing angles
- Three-year guarantee



**3 Year
WARRANTY**



VISION PLUS TV Wall Brackets



A complete range of six bespoke, strong, lightweight, fibre reinforced polymer TV brackets.

Incorporating our unique Quick Release TV plate, the In-Transit Lock and locking arms. All conceived, designed and manufactured here in Nottingham and aimed specifically at our mobile market.

Designed by Vision Plus, the Quick release Bracket enables your TV to be quickly removed, no tools required. Available as a stand alone product and integrated in all our Wall Brackets.



**2 Year
WARRANTY**

Double Arm
Bracket



Single Arm
Bracket

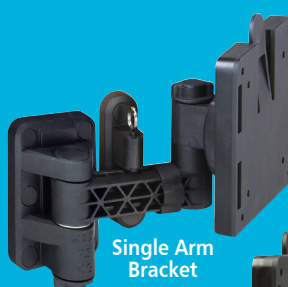

Short Arm
Bracket



Triple Arm
Bracket



Quad Arm
Bracket



Quick Release
Bracket

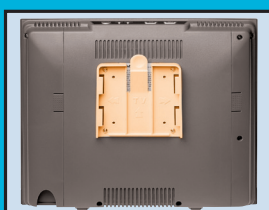

One plate fixes
to your TV

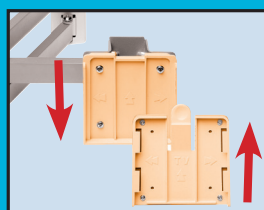

Another attaches
to a bracket



A complete
installed assembly

RANGER Rear View Camera System

The height and length of many vehicles greatly inhibit the driver's visibility. Driving positions, bulky bodywork panels and the absence of rear windows create further issues.

Why have a Ranger Rear View Camera?

- See who and what's behind you
 - Reverse with more confidence
 - Increase your vision on the move
 - Reduce your blind spots
 - Helps avoid collisions
 - Avoid costly body repairs
 - Potential for reduced insurance premiums*
- *Subject to your insurance provider.

Which MONITOR?

All have the following main features

- Selectable reversing grid
- Built-in Speaker
- Auto switching of cameras
- Remote control

7" Clip-over Mirror Monitor



- Brightness 450 cd/m2
- Resolution 1440 x 235
- W245 x D30 x H95mm

7" Colour Monitor



- Soft touch casing and visor
- W170 x D20 x H115mm
- Brightness 450 cd/m2
- Sucker Mount
- Resolution 1440 x 235

5" Colour Monitor



- Soft touch casing and visor
- W130 x D50 x H85mm
- Brightness 350 cd/m2
- Sucker Mount
- Resolution 800 x 480

All cameras have slimline connectors requiring only a 10mm hole



Which CAMERA?

All have the following main features

- Day and Night Vision
- Adjustable viewing angles
- Slimline connectors

Double or single camera?

A single camera has a 120° viewing angle and is generally angled down to assist with reversing manoeuvres with vision to the rear of the van.

A double camera allows greater range of vision by combining the 120° with a second 45° camera unit which is positioned for distance. This is continually displayed on the monitor.

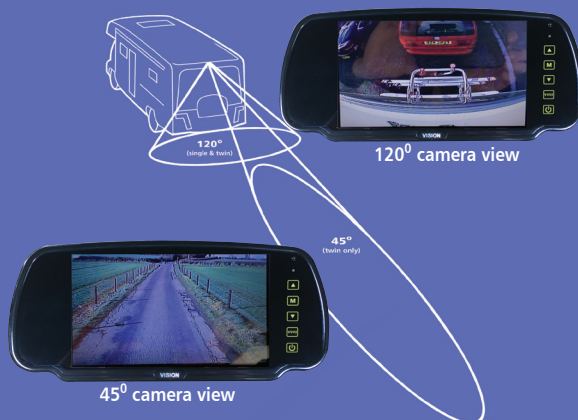

Slimline Double camera



Slimline Single camera



Bracket cameras - double/single



RANGER Models				
	210	220	230	240
	310	320	330	340
	410	420	430	440

...Harness the Power of the Sun...

SOLAR Battery Charger System

The SOLAR Battery Charger System is designed as an expandable system for those looking for power independence but unsure of their power requirements.

The system is designed around the 50W or 100W MASTER Panel and the high specification Power Controller which allows the addition of ADD-ON Panels to give a maximum capacity of 250W.

Once the MASTER Panel is installed, ADD-ON Panels simply glue into place, no special tool or drilling of holes required.

The ADD-ON Panels come fitted with the female link cable with integrated waterproof cap, plus the 3 metres of white male link cable to allow maximum flexibility when locating additional panels on the roof.

MASTER Panel includes

- 50 or 100 Watt solar panel
- 20 Ah Charge controller
- Roof mount cable gland
- 5 metres of power cable
- 350 mm female link-cable with water proof cap
- In-line fuse
- Connectors & Fittings
- Full Instructions

ADD-ON Panel includes

- 50 or 100 Watt solar panel
- 3 metres of link cable in white
- 350 mm female link-cable with water proof cap
- Connectors & Fittings

Specification

- 20 Year warranty on cell output
- IP68 Rating for Link Plugs
- Panel Dimensions: 100W - 660 x 456 x 57 mm
50W - 660 x 505 x 57 mm
- Panel Weight: 100W - 7.3Kg
50W - 4.2Kg
- Operating Temperature: -40° to +85°C



20 Year
CELL OUTPUT
WARRANTY

First, the MASTER

50/100Watts

If you need more capacity, it's expandable

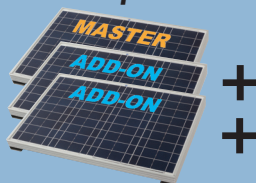

Just add panels to a total of

250Watts

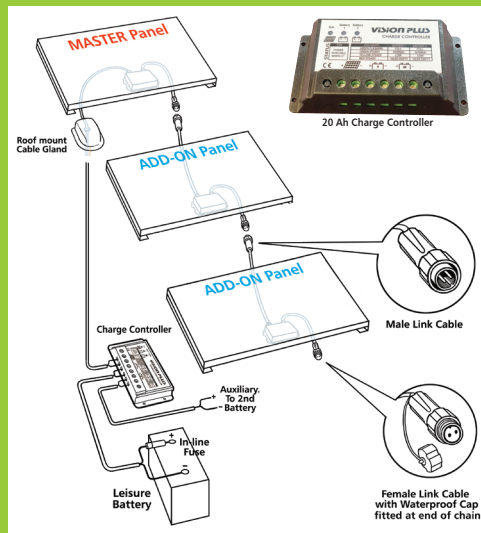

The performance of the solar panel and its ability to charge your battery will be dependent upon the quality of ambient daylight. In full sunlight, it would be 100% efficient, sunny intervals 80% and cloudy 50%.



What Do I Need?

